

versatile™ 4C Surface Mount Collar, SM16S

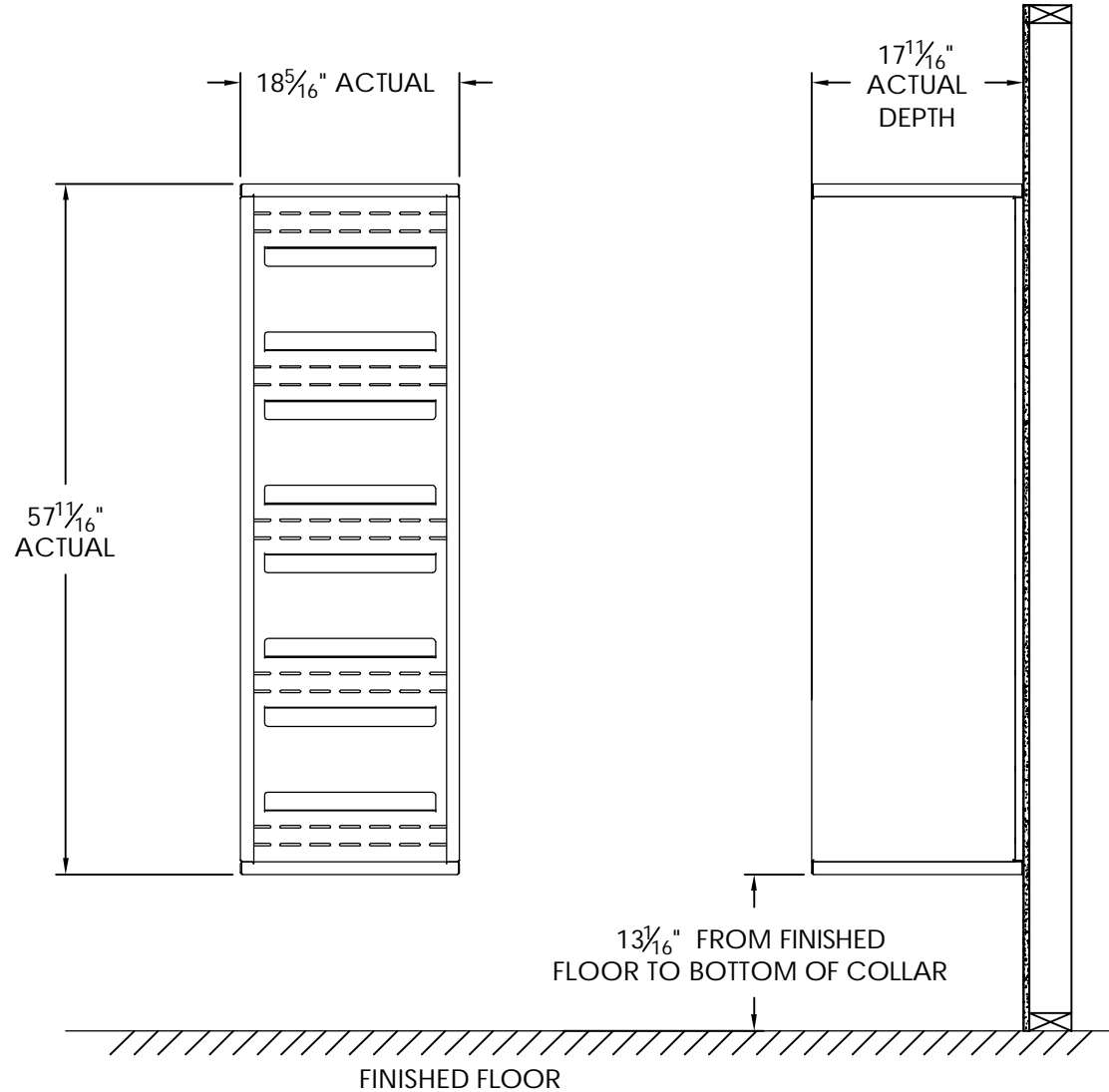

Notes:

1. Designed to mount Florence Versatile™ 4C mailbox single column Max Height Suite modules (sold separately).
2. For use with front loading modules only.

PRODUCT SERIES: VERSATILE™ 4C SURFACE MOUNT COLLAR

AF FLORENCE
manufacturing company

5935 Corporate Drive • Manhattan, KS 66503
www.florencemailboxes.com • (800) 275-1747

A GIBRALTAR INDUSTRIES COMPANY

| | | | |
|----------------|---------|---------------|-----------|
| MODEL | SM16S | REV | C |
| SCALE | NONE | LAST REV DATE | 7/03/2014 |
| DRAWING NUMBER | SM16SCS | DRAWN BY | TNS |

versatile™ 4C Mailbox, 4C16S-03

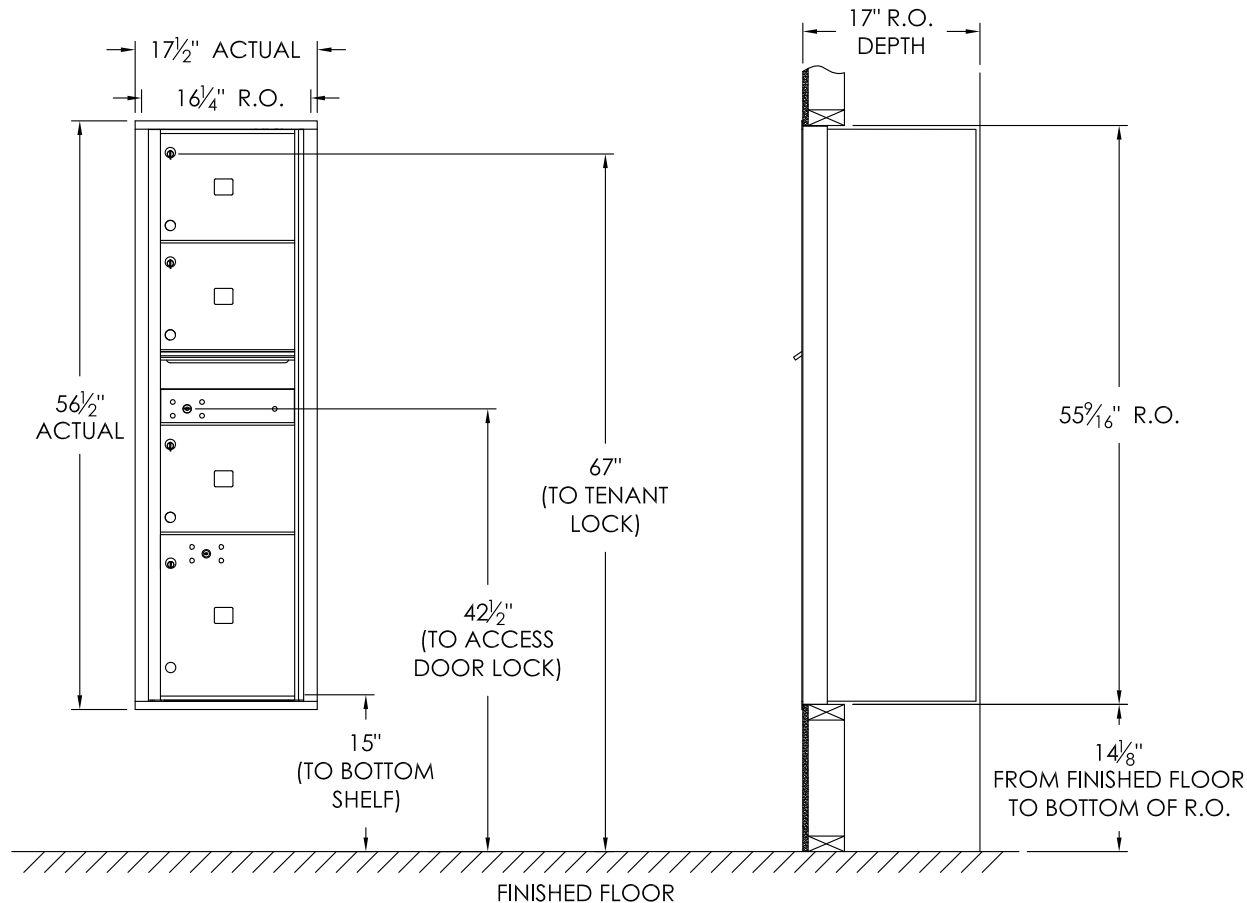

COMPARTMENT CHART

| DESCRIPTION | COMPARTMENT | COMPARTMENT SIZE | QTY. |
|---------------|-------------|--------------------------|------|
| MAILBOX | MB3 | 10" H x 12" W x 15" D | 3 |
| OUTGOING MAIL | OM2 | 6-1/2" H x 12" W x 15" D | 1 |
| PARCEL LOCKER | PL15 | 15" H x 12" W x 15" D | 1 |

Notes:

- This module meets the USPS STD-4C requirements for installation defined below when the mailbox is installed per the dimensions provided on this drawing.
 - At least one customer compartment shall be positioned less than 48" above finished floor (AFF).
 - No parcel locker (interior bottom shelf) shall be positioned less than 15" AFF.
 - No patron (tenant) lock shall be positioned more than 67" AFF.
 - No customer compartment (interior bottom shelf) shall be positioned less than 28" AFF.
 - The USPS Arrow lock shall be positioned 36"- 48" AFF.
- This 4C mailbox can also be used for private applications.
- The rough opening width for multi-unit 4C installations = (the sum of all actual unit widths) - 1 1/8".

PRODUCT SERIES:

VERSATILE™ 4C FRONT LOAD MAILBOX

FLORENCE
CORPORATION

5935 Corporate Drive • Manhattan, KS 66503
800 275 1747 • www.florencemailboxes.com

| | |
|---------------------------|-----------------------|
| MODEL 4C16S-03 | REV C |
| SCALE NONE | LAST REV DATE 2/23/17 |
| DRAWING NUMBER 4C16S-03CS | DRAWN BY NBC |